

GEZE

IQ Bar 200 Series

Panic & Emergency Exit
Hardware

GB Installation instructions

143800-01



Table of Contents

1	About this document.....	3
1.1	Product description.....	3
1.2	Key to symbols.....	3
2	Safety and responsibility.....	3
2.1	General safety instructions	3
2.2	Product liability.....	3
3	Product overview.....	4
3.1	Technical parts list.....	4
3.2	Hardware range	5
4	Fixing and installation	6
4.1	Introduction.....	6
4.2	IQ Bar 201/ IQ Pad 201	7
4.3	IQ Bar 202 V A / IQ Bar 203 V A / IQ Pad 202 V A / IQ Bar 204 V DL	9
4.4	IQ Bar 203 H / IQ Pad 203 H.....	12
4.5	IQ Bar 202 V.....	14
4.6	Lever 200 L - Outside Access Device (OAD)	16
4.6.1	Preparing the device	17
4.6.2	Fitting the device.....	17
5	Notes on installation	19
6	Maintenance instructions.....	20
7	Drilling templates.....	21
7.1	Drilling Template 0071 - Main Unit / Slave Fitting Template.....	22
7.2	Drilling Template 0072 - Flush Doors / 1st Opening Double Door	23
7.3	Drilling Template 0073 - Vertical Pullman Catches Fitting Template.....	24
7.4	Drilling Template 0074 - Horizontal Pullman Catches Fitting Template	25
7.5	Drilling Template 0075 - Lever 200 L - Template for positioning optional 3rd additional fixing hole.....	26

1 About this document

These instructions describe the installation of the GEZE IQ Panic & Emergency Exit hardware.



1.1 Product description

The GEZE IQ Panic & Emergency Exit hardware devices are designed to give instant escape, when required, by means of either a push bar or push pad on single or double doors, and can be operated from the outside of the door by an outside access device. When the outside access device is locked the door can still be released from the inside.

1.2 Key to symbols

Symbols used in these instructions

Important information and technical notes are emphasised to illustrate the correct operation.

Symbol	Meaning
	means "Important note"
	means "Additional information"
	Symbol for a user action. Here you have to take an action. Observe the sequence if there are several action steps.

2 Safety and responsibility

The GEZE IQ Panic & Emergency Exit hardware device has been designed according to the latest technical standards and acknowledged safety rules and regulations. Dangers can, nevertheless, occur in its installation and use. You must therefore observe the following instructions.

2.1 General safety instructions

- Installation, commissioning and repairs must be performed only by GEZE-authorized specialists.
- Use only genuine GEZE parts for repairs.
- GEZE accepts no liability for damage arising from unauthorized modifications to the installation.
- Primary building safety measures must be taken by the owner.
- Cables must be laid according to standards VDE 0100 and VDE 0815.
- Doors with electrical locks along escape routes should be inspected annually by a specialist. The specialist must issue a certificate verifying the periodic inspection, which the owner must submit to the building inspectorate on request. The inspection can be performed by a GEZE service technician or a GEZE-authorized service provider.
- In addition, GEZE recommends a monthly inspection of the exit hardware device for visible damage and faults by the owner. Any identified damage or faults must be rectified immediately by a GEZE service technician or a GEZE-authorized service provider.
- In order to meet the CEN European Standards the door and frame should be of good quality and suitable to support the hardware.

Improper use

Improper use includes the connection of any products that are not expressly approved by GEZE.

2.2 Product liability

- According to manufacturers liability for their products as defined in the German product liability act, the information contained herein and in the associated installation instructions and diagrams must be observed. Non-observation frees the manufacturer from their liability.
- Installation, function testing and maintenance must be performed only by GEZE-authorized personnel. GEZE accepts no liability for damage arising from unauthorized modifications to the installation.
- A combination with third-party devices invalidates GEZE's warranty. For repair and maintenance, use only original GEZE parts.

3 Product overview

3.1 Technical parts list

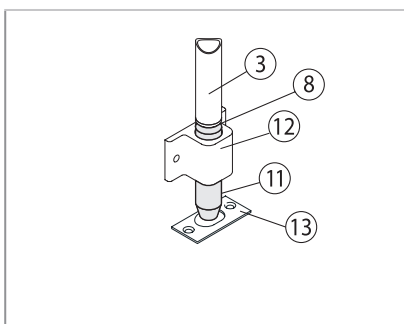
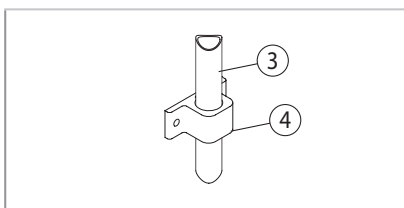
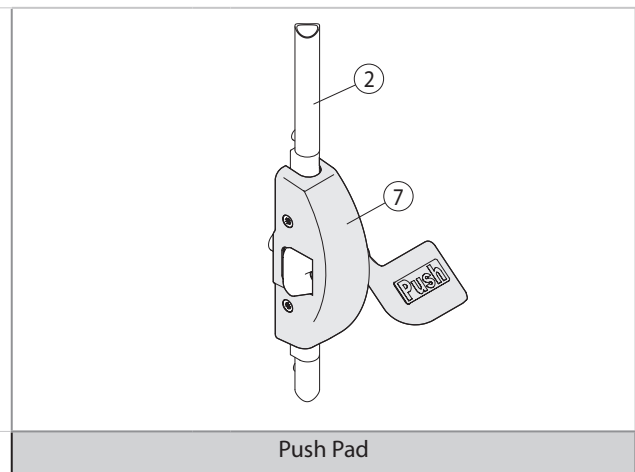
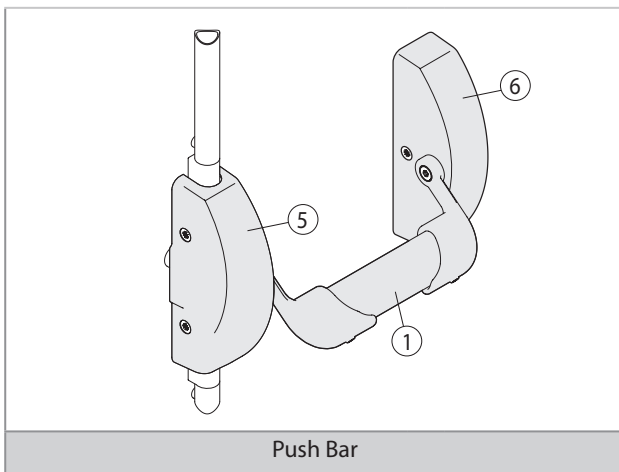
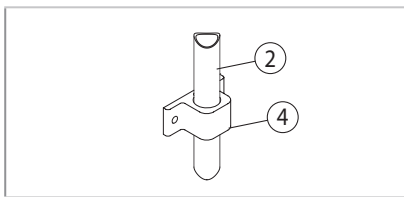
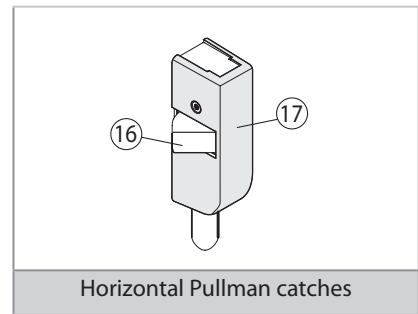
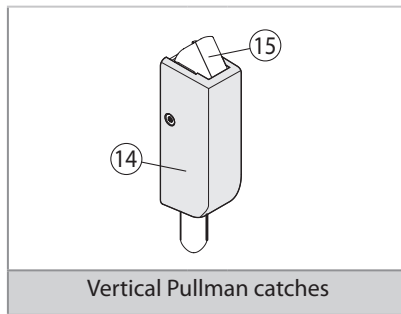
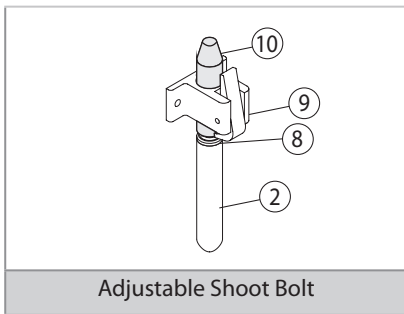

- 1. Oval push bar
- 2. Top shoot tube
- 3. Bottom shoot tube
- 4. Tube guide
- 5. Push bar main unit
- 6. Slave unit
- 7. Push pad main unit
- 8. Shoot bush
- 9. Top trip guide
- 10. Top shoot end plug
- 11. Bottom shoot end plug
- 12. Adjustable bottom tube guide
- 13. Alternative floor plate
- 14. Vertical pullman catch cover
- 15. Vertical pullman latch
- 16. Horizontal pullman latch
- 17. Horizontal pullman catch cover

3.2 Hardware range

Single Door Sets

Centre Latch

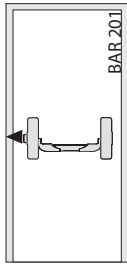

IQ BAR 201
Push Bar
1 Point Panic Latch

Adjustable Bolts

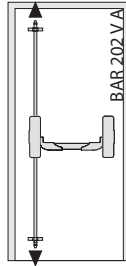

IQ BAR 202 V A
Push Bar
2 Point Panic Bolt
adjustable shoot bolts

Horizontal Pullman Catches

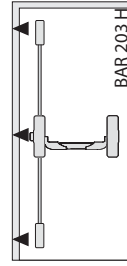

IQ BAR 203 H
Push Bar
3 Point Panic Bolt
horizontal pullman catches

Vertical Pullman Catches

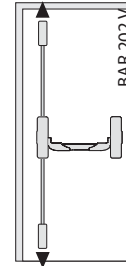

IQ BAR 202 V
Push Bar
2 Point Panic Bolt
vertical pullman catches

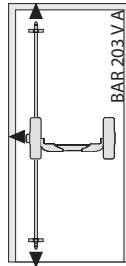

IQ BAR 203 V A
Push Bar
3 Point Panic Bolt
adjustable shoot bolts

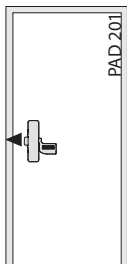

IQ PAD 201
Push Pad
1 Point Emergency Exit Latch

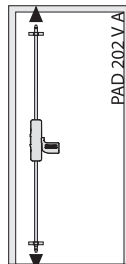

IQ PAD 202 V A
Push Pad
2 Point Emergency Exit Bolt
adjustable shoot bolts

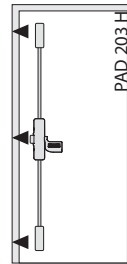

IQ PAD 203 H
Push Pad
3 Point Emergency Exit Bolt
horizontal pullman catches

Double Door Sets

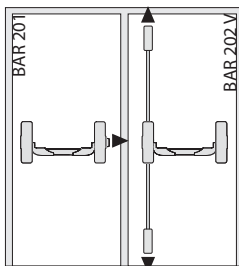

IQ Bar 203 V DL
Push Bar
3 Point Double Door Set
for rebated double doors

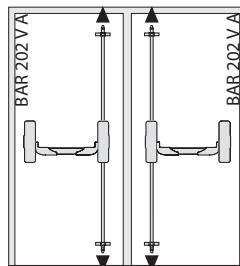

IQ Bar 204 V DL
Push Bar
4 Point Double Door Set
for non rebated double doors

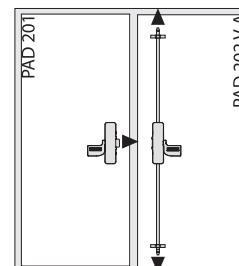

IQ Pad 203 V DL
Push Pad
3 Point Double Door Set
for rebated double doors

4 Fixing and installation

4.1 Introduction

- This exit devices are suitable for right or left hand opening doors of up to 2440mm (8') high x 1220mm (4') wide.
- The door must weigh no more than 200kg and be mounted in a good quality well made frame.
- The door/doors should be checked to ensure correct hanging and freedom from binding.
- It is not recommended that the exit device is fitted to hollow core doors.
- The exit devices are not intended for use on double action (double swing) doors.
- Ensure that no weather strips or fixings on the door or door frame stop the device from working properly.
- If the door is to be fitted with a device which allows you to open it from outside, read the instructions provided with that device.
- All measurements are in millimetres.
- For installation of double door sets refer to the instructions of the relevant single door units.
 - IQ Bar 203 V DL = IQ Bar 201 + IQ Bar 202 V
 - IQ Bar 204 V DL = IQ Bar 202 V A + IQ Bar 202 V A
 - IQ Pad 203 V DL = IQ Pad 201 + IQ Pad 202 V A

4.2 IQ Bar 201/ IQ Pad 201

These units can be fitted on a single door or on the first opening (active) leaf of one of the following rebated double doors sets.

- Set IQ Bar 203 V DL together with IQ Bar 202 V fitted on the last opening (inactive) leaf.
- Set IQ Pad 203 V DL with IQ Pad 202 V A fitted on the last opening (inactive) leaf.

If the unit is to be fitted on double rebated doors a revised fitting position for the unit is however required as shown in these installation instructions.

Step A: Preparing the device

- ▶ Hand the main unit by removing the packaging and gently rotate the arm in the required direction (see diagram Step G) until it clicks. The unit is now handed. If handed incorrectly by mistake refer to Step G.
- ▶ Remove the mounting plate from the bottom of the main operating unit (pull out).

Step B: Fitting the mounting plate

- ▶ Determine the centre height (A) of the unit between 930mm and 1130mm from floor level. Mark this position on the edge of the door frame on both sides of the inside of the door. For double doors also mark this position on the edge of the inactive leaf.



Note: The centre of the Push Bar/Pad will fall approximately 30mm below this.

- ▶ Starting at the opening edge, place the template (DT-0071) on the door and slide into the jamb rebate (you may need to cut or fold the template) align with the unit centre line and the jamb line and stick to the door with sticky tape.

For **rebated double doors** align the correct line on the double door template (DT-0072) with the edge of the inactive leaf and the unit centre line.

- ▶ Mark the positions of the holes for the mounting plate. Follow the instructions on the relevant template and drill the required holes.
- ▶ Fix the mounting plate to the door.



All 6 fixing holes must be used and screw heads must not project above plate.

IQ Bar 201 only

- ▶ Hand the slave, same process as the main unit (Step A), but the opposite hand.
- ▶ Repeat the steps above to fit the slave unit mounting plate to the hinge side of the door. Fix this mounting plate to the door also using all 6 fixing screws.



In case of using an outside access device (lever) pause the installation of the exit device and fit the lever before continuing with the installation. Refer to chapter "Lever 200 L - (OAD)

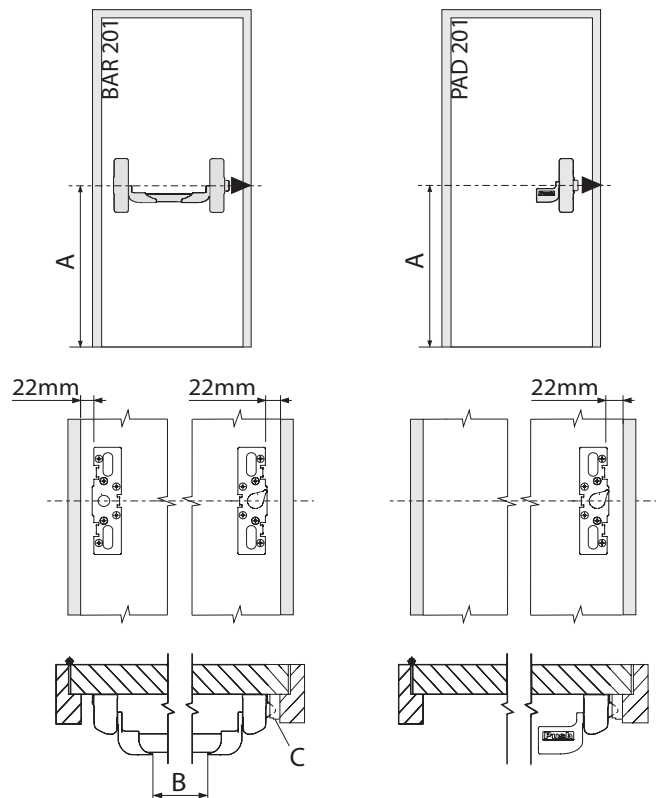

- A Unit Centre Height: between 930mm & 1130mm
- B Oval Push Bar Length = B + 61mm
- C Centre Latch Keep No. 0140
- D Distance from the edge of the last opening leaf to Tube Centre Line = minimum 50mm
- E Rebated Double Door Keep No. 0144

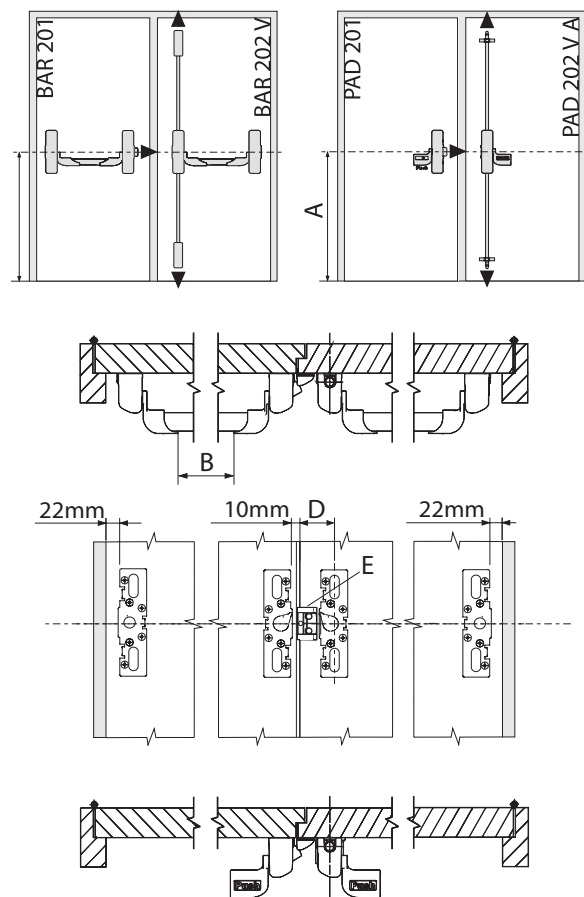

Step C: Fitting the main operating unit

- ! Rotate the mounting plate cam to the correct position (see template) and fit the main operating unit onto the mounting plate.

- ▶ Secure using 3 off M5 x 8 CSK Screws provided.

Step D: Fitting the keep**Single door**

- ▶ With the door closed, position the included centre latch keep No. 0140 (C) centred about the latch with the flat face against the door face.
- ▶ Mark the positions of the fixing holes.
- ▶ Fix in place using the countersunk screws provided.

Rebated Double doors

- ▶ For rebated double doors use the included keep No. 0144 (E). Position on last opening leaf with 'lip' against edge of door and centre about the latch (see diagram).
- ▶ Mark the positions of the fixing holes.
- ▶ Fix in place using the screws provided.
- ▶ Fit as shown and adjust with the packers provided until the correct engagement is achieved.

Step E: Fitting the slave unit & oval cross bar**IQ Bar 201 only**

- ▶ Temporarily fit the slave unit onto the mounting plate.
- ▶ Measure accurately the arm gap (B) (see diagram) add 61mm to this dimension and cut oval cross bar to this length.
- ▶ Remove slave unit from its mounting plate insert one end of oval cross bar into the main unit arm and the other into the slave unit arm.
- ▶ Refit the slave unit onto the mounting plate and secure using three of M5x8 CSK Screws provided.

- ! ▶ Secure the cross bar with the two of M4x6 set screws one in each arm.

DO NOT OVER TIGHTEN**Step F: Testing the operation & fitting the sign.**

- ▶ Test the unit to ensure that when the Push Bar/ Pad is operated the door opens immediately and swings freely. When closed the centre latch engages fully in the keep and holds the door securely shut.
- ▶ Fit the green self adhesive 'Push Bar to Open' / 'Push Pad to Open' sign onto the door positioned immediately above the Push Bar/Pad.

Step G: Re-Handing the unit (If required)

If either unit is handed the wrong way in error, please follow these instructions.

- ▶ Turn the unit upside down & pull out the mounting plate to remove it (if required)
- ▶ Slide a small flat bladed screwdriver into the smaller bit of the large aperture along the inside face of the steel chassis inserting it between the chassis and the handing cam (see the diagram).
- ▶ Gently lever the cam forward until it disengages from the arm spindle.
- ▶ Rotate the arm to re-hand the unit the required way (ensure the cam is fully engaged).

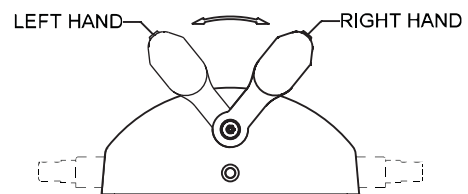

INSERT FLAT SCREWDRIVER HERE

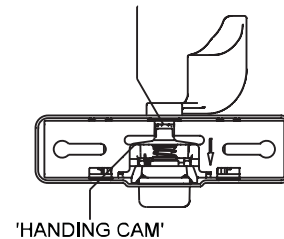

4.3 IQ Bar 202 V A / IQ Bar 203 V A / IQ Pad 202 V A / IQ Bar 204 V DL

These units can be fitted on a single door or in one of the following double door sets:

- Set IQ Bar 204 V DL with IQ Bar 202 V A fitted on both leaves of non rebated double doors.
- Set IQ Pad 203 V DL with IQ Pad 202 V A fitted on the last opening (inactive) leaf of double rebated doors together with IQ Bar 201 on the first opening (active) leaf. In this case a revised fitting position for this unit is however required, which is shown in the relevant section of these instructions relating to that device.

Step A: Preparing the device

- ▶ Hand the main unit by removing the packaging and gently rotate the arm in the required direction (see diagram Step I) until it clicks. The unit is now handed. If handed incorrectly by mistake refer to Step I.
- ▶ Remove the mounting plate from the bottom of the main operating unit (pull out).

Step B: Fitting the mounting plate

- ▶ Determine the centre height (A) of the unit between 930mm and 1130mm from floor level. Mark this position on the edge of the door frame on both sides of the inside of the door. For double doors also mark this position on the edge of the inactive leaf.

i **Note:** The centre of the Push Bar/Pad will fall approximately 30mm below this.

- ▶ Starting at the opening edge, place the template (DT-0071) on the door and slide into the jamb rebate (you may need to cut or fold the template) align with the unit centre line and the jamb line and stick to the door with sticky tape. For Non-Rebated double doors align the correct line on the template (DT-0071) with the edge of its door leaf. Repeat the process on the second door.
- ▶ Mark the positions of the holes for the mounting plate. Follow the instructions on the relevant template and drill the required holes.
- ▶ Fix the mounting plate to the door.
- ▶ Repeat the process on the second door.

! All 6 fixing holes must be used and screw heads must not project above plate.

IQ Bar 202 V A & 203 V A only

- ▶ Hand the slave, same process as the main unit (Step A), but the opposite hand.
- ▶ Repeat the steps above to fit the slave unit mounting plate to the hinge side of the door. Fix this mounting plate to the door also using all 6 fixing screws.

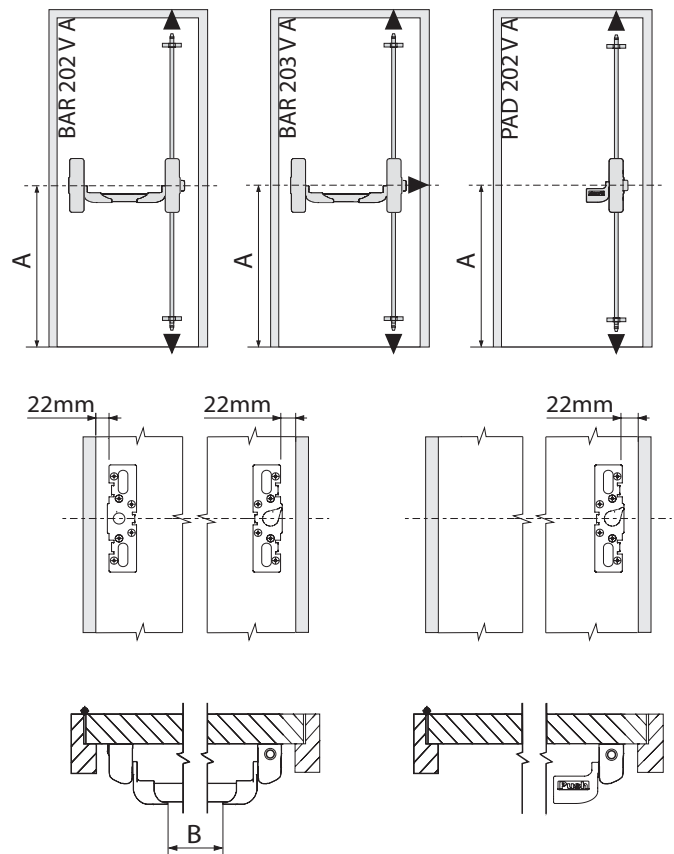

- A Unit Centre Height: between 930mm & 1130mm
- B Oval Push Bar Length = B + 61mm

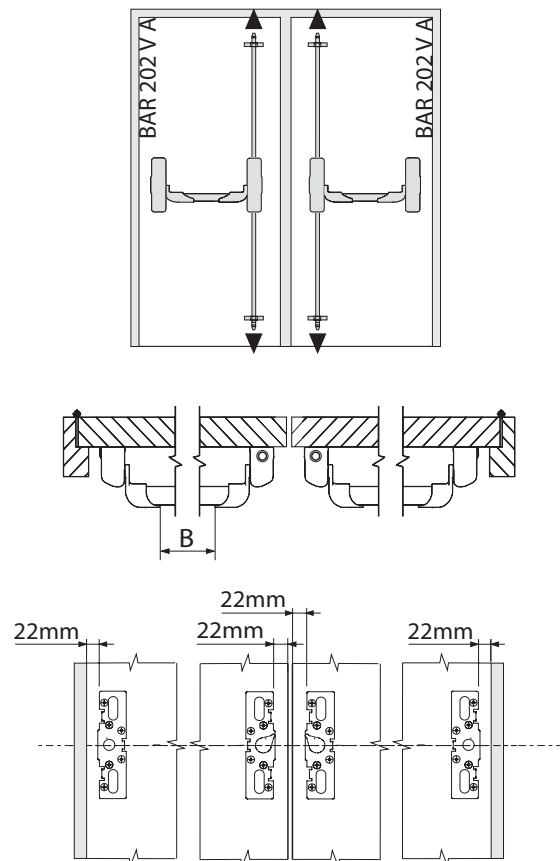

- i** In case of using an outside access device (lever) pause the installation of the exit device and fit the lever before continuing with the installation. Refer to chapter Lever 200 L - (OAD)

Step C: Preparing the shoot tubes.

- !** Rotate the mounting plate cam to the correct position (see template) and fit the main unit onto the mounting plate.
- Temporarily secure using one of the supplied M5 x 8 CSK screws.
- Measure accurately the bottom length (F) (from bottom spigot shoulder to floor / frame / face of keep), subtract 70mm and cut the **plain end** of the **shorter tube** to this length.
- Drive one of the threaded bushes into cut end of this tube. Bush **must** be driven in fully against the tube end. Screw in the bottom (plain) shoot end plug, leaving an 8mm Gap.
- Measure accurately the top length (G) (from top spigot shoulder to frame / face of keep), subtract 66mm and cut the **plain end** of the **longer tube** to this length.
- Drive the second threaded bush into cut end of this tube. Bush **must** be driven in fully against the tube end. Screw in the top (grooved) shoot end plug, leaving an 8mm gap.

Step D: Fitting the shoot tubes, bottom guides & main operating unit.

- Remove the main operating unit from the door.
- Fit the previously prepared top & bottom shoot tubes (section B) onto the operating unit's shoot spigots. Secure with the M5x10 cap head screws provided, with the screw heads facing the door face.
- Slide one standard (narrow) guide onto the top tube.
- Slide one standard (narrow) guide followed by the wide guide onto the bottom tube.
- Ensure the mounting plate cam is in the correct position** (approximately 2 o'clock or 10 o'clock position, dependant on handing, see template).
- Fit unit back onto the mounting plate and secure using 3 M5x8 CSK Screws provided.
- Locate the adjustable bottom tube guide the correct distance from the floor / frame (see diagram) and secure using the round headed screws provided.
- Locate the bottom middle guide equidistant on the tube (see diagram) and secure using the round headed screws provided. Ensuring the tube is vertical and the guides are in alignment.

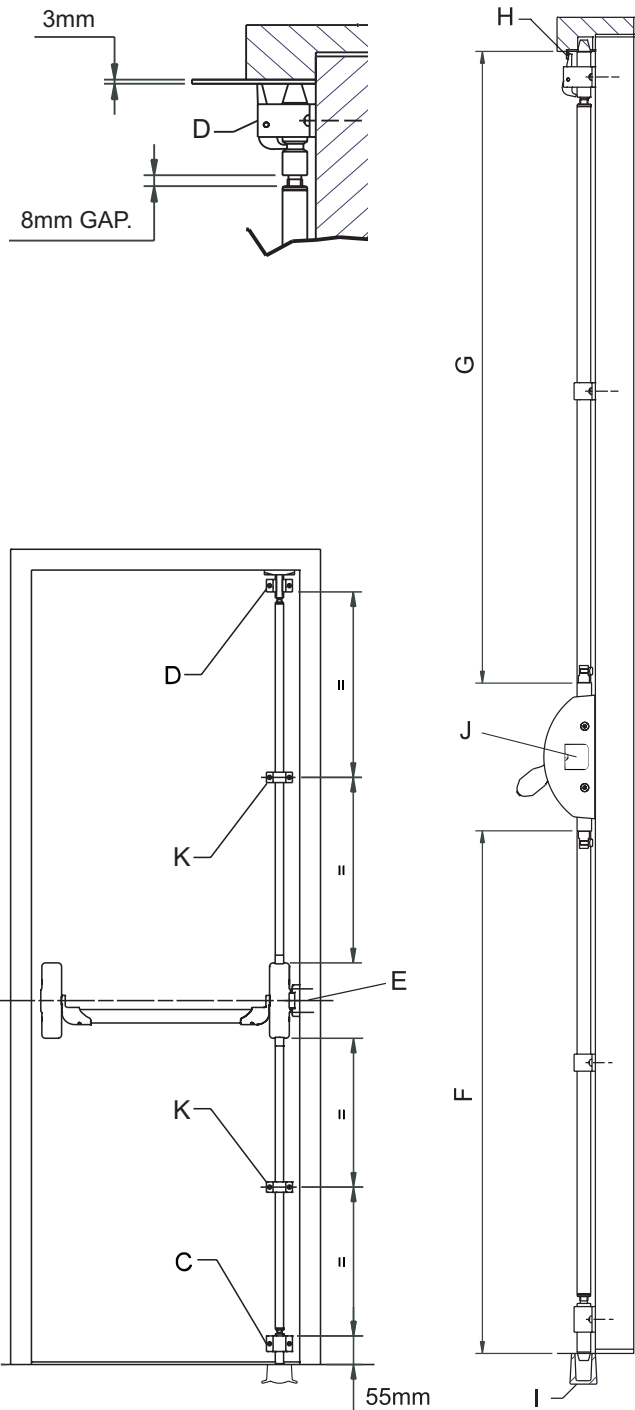

- C Adjustable Bottom Tube Guide
- D Top Trip Guide
- E Centre Latch Keep (IQ Bar 203 V A only)
- F Bottom Shoot Tube Length
- G Top Shoot Tube Length
- H Top Trip Plate
- I Easy Clean Socket
- J Centre Latch (IQ Bar 203 V A only)
- K Tube Guides

Step E: Fitting the top trip & top guide.

- ▶ Keeping the operating arm fully depressed. Locate the top trip guide device on the top shoot end plug. Use a 3mm thick spacer between the end of the top shoot and the underside of the frame / face of keep, to ensure that the shoot is fully withdrawn. Secure top trip guide to door using the round headed screws provided.
- ▶ Locate the top middle guide equidistant on the tube (see diagram) and secure using the round headed screws provided. Ensuring the tube is vertical and the guide and top trip are in alignment.
- ▶ Operate the exit device to ensure the top trip guide holds both shoots in the fully withdrawn position when the door is open.

Step F: Fitting the keeps.

- ▶ Fit the top trip plate (H) morticed flush into the frame, with its narrow edge level with the door rebate (see diagram). Fix with the short (3/4" Long) countersunk screws provided.
- ▶ For solid floors fit the easy clean socket. Fit flush with the finished floor surface with its edge level with the inside door face. For wooden floors fit the alternative floor plate. Fit flush with the finished floor surface with the narrow edge level with the inside door face.

IQ Bar 203 V A only

- ▶ With the door closed, position the centre latch keep (E) centred about the latch (J) with the flat face against the door face. Mark the positions of the fixing holes. Fix in place using the countersunk screws provided."

Step G: Fitting the slave unit & oval cross bar.**IQ Bar 202 V A & 203 V A only**

- ▶ Temporarily fit the slave unit onto the mounting plate.
- ▶ Measure accurately the Arm Gap B (see diagram) add 61mm to this dimension and cut oval cross bar to this length.
- ▶ Remove slave unit from its mounting plate insert one end of oval cross bar into the main unit arm and the other into the slave unit arm.
- ▶ Refit the slave unit onto the mounting plate and secure using three of M5x8 CSK Screws provided.



- ▶ Secure the cross bar with the two of M4x6 set screws one in each arm.

DO NOT OVER TIGHTEN**Step H: Testing the operation & fitting the sign.**

- ▶ Test the unit to ensure that when the Push Bar/ Pad is operated the door opens immediately and swings freely. When the door is open the shoots are held fully withdrawn and when closed the shoots (and centre latch if present) engage fully in their keepers and hold the door securely closed.
- ▶ Fit the green self adhesive 'Push Bar to Open' / 'Push Pad to Open' sign onto the door positioned immediately above the Push Bar/Pad.

Step I: Re-Handing the unit (If required)

If either unit is handed the wrong way in error, please follow these instructions.

- ▶ Turn the unit upside down & pull out the mounting plate to remove it (if required)
- ▶ Slide a small flat bladed screwdriver into the smaller bit of the large aperture along the inside face of the steel chassis inserting it between the chassis and the handing cam (see the diagram).
- ▶ Gently lever the cam forward until it disengages from the arm spindle.
- ▶ Rotate the arm to re-hand the unit the required way (ensure the cam is fully engaged).

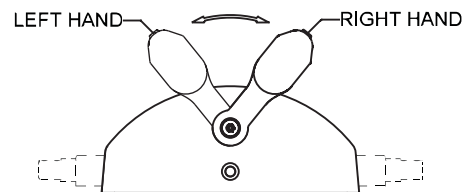

INSERT FLAT SCREWDRIVER HERE

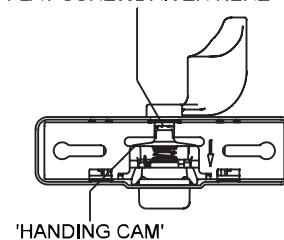

4.4 IQ Bar 203 H / IQ Pad 203 H

Step A: Preparing the device

- ▶ Hand the main unit by removing the packaging and gently rotate the arm in the required direction (see diagram Step I) until it clicks. The unit is now handed. If handed incorrectly by mistake refer to Step I.
- ▶ Remove the mounting plate from the bottom of the main operating unit (pull out).

Step B: Fitting the mounting plate

- ▶ Determine the centre height (A) of the unit between 930mm and 1130mm from floor level. Mark this position on the edge of the door frame on both sides of the inside of the door.



Note: The centre of the Push Bar/Pad will fall approximately 30mm below this.

- ▶ Starting at the opening edge, place the template (DT-0071) on the door and slide into the jamb rebate (you may need to cut or fold the template) align with the unit centre line and the jamb line and stick to the door with sticky tape.
- ▶ Mark the positions of the holes for the mounting plate. Follow the instructions on the template and drill the required holes.
- ▶ Fix the mounting plate to the door.



All 6 fixing holes must be used and screw heads must not project above plate.

IQ Bar 203 H only

- ▶ Hand the slave, same process as the main unit (Step A), but the opposite hand.
- ▶ Repeat the steps above to fit the slave unit mounting plate to the hinge side of the door. Fix this mounting plate to the door also using all six fixing screws.



In case of using an outside access device (lever) pause the installation of the exit device and fit the lever before continuing with the installation. Refer to chapter Lever 200 L - (OAD)

Step C: Positioning and fitting the pullman catches.

- ▶ Determine the height of the catches on the door.
- ▶ Place the template (DT-0074) on the door. Line up the appropriate lines. Mark the corresponding holes.
- ▶ Follow the instructions on the relevant template and drill the required holes.
- ▶ Remove the covers from the pullman units (2 cover screws).
- ▶ Fit each pullman catch using all three CSK screws provided. Note: to access two of the three screw holes; move the slide plate mechanism.

Screw heads must be fully in the counter-sunk holes and not stand proud.

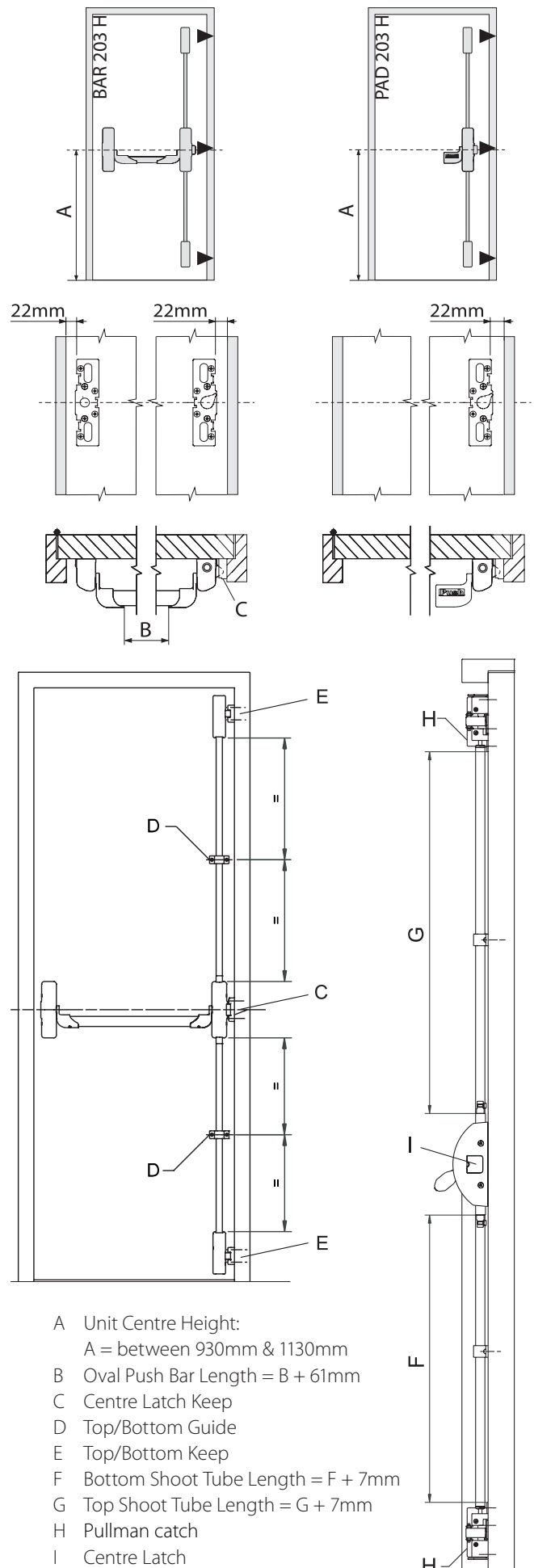

- A Unit Centre Height:
A = between 930mm & 1130mm
- B Oval Push Bar Length = B + 61mm
- C Centre Latch Keep
- D Top/Bottom Guide
- E Top/Bottom Keep
- F Bottom Shoot Tube Length = F + 7mm
- G Top Shoot Tube Length = G + 7mm
- H Pullman catch
- I Centre Latch

Step D: Preparing the shoot tubes.

- ! Rotate the mounting plate cam to the correct position (see template) and fit the main unit onto the mounting plate.
- ▶ Temporarily secure using one of the supplied M5 x 8 CSK screws.
 - ▶ Measure accurately length (F), add 7mm and cut the **plain end** of the **shorter tube** to this length.
 - ▶ Measure accurately length (G), add 7mm and cut the **plain end** of the **longer tube** to this length.
 - ▶ Using the installation drift tube to prevent screw thread damage, drive the threaded shoot end plug into cut ends of both tubes. Plug **must** be driven in fully against the tube end.
 - ▶ Re-fit the pullman catches (two cover screws, each)

Step E: Fitting the shoot tubes, tube guides & main operating unit.

- ▶ Remove the main operating unit from the door.
- ▶ Screw the previously prepared shoot tubes (section C) fully into the pullman catches.
- ▶ Slide the tube guides onto the tubes (one on each tube)
- ▶ **Ensure the mounting plate cam is in the correct position (see template).**
- ▶ Place the main operating unit onto the mounting plate allowing the tubes to drift to one side.
- ▶ Operate the main operating unit mechanism to retract the shoot spigots. Guide the shoot tubes into position and slowly release the mechanism whilst guiding the spigots into the end of the tubes.
- ▶ Unscrew the tubes from the pullman catches until they almost contact the shoulder on the shoot spigots. Rotate the tubes back until the holes are facing the door.
- ▶ Pull the unit away from the door and secure the tubes using the M5x10 cap head screws provided.
- ▶ Fit unit back on the mounting plate and secure using three M5x8 CSK Screws.
- ▶ Locate the guides equidistant on the tubes (see diagram) and secure using the round headed screws provided. Ensuring the tubes are vertical and the guides are in alignment.

Step F: Fitting the keeps.

- ▶ Position the included top/bottom keeps centred about the catch with the square face of the keep against the door (see diagram) and mark the holes. Fix in place using the countersunk screws provided.
- ▶ With the door closed, position the centre latch keep around the centre latch with the flat face against the door face. Mark the positions of the fixing holes. Fix in place using the countersunk screws provided.

Step G: Fitting the slave unit & oval cross bar**IQ Bar 203 H only**

- ▶ Temporarily fit the slave unit onto the mounting plate.
- ▶ Measure accurately the arm gap (B) (see diagram) add 61mm to this dimension and cut Oval cross bar to this length.
- ▶ Remove slave unit from its mounting plate insert one end of oval cross bar into the main unit arm and the other into the slave unit arm.
- ▶ Refit the slave unit onto the mounting plate and secure using three of M5x8 CSK Screws provided

- ! ▶ Secure the cross bar with the two of M4x6 set screws one in each arm.
DO NOT OVER TIGHTEN

Step H: Testing the operation & fitting the sign.

- ▶ Test the unit to ensure that when the Push Bar/ Pad is operated the door opens immediately and swings freely. When the door is closed the pullman catches and centre latch engage fully in their keeps and hold the door securely closed.
- ▶ Fit the green self adhesive 'Push Bar to Open' / 'Push Pad to Open' sign onto the door positioned immediately above the Push Bar/Pad.

Step I: Re-Handing the unit (If required)

If either unit is handed the wrong way in error, please follow these instructions.

- ▶ Turn the unit upside down & pull out the mounting plate to remove it (if required)
- ▶ Slide a small flat bladed screwdriver into the smaller bit of the large aperture along the inside face of the steel chassis inserting it between the chassis and the handing cam (see the diagram).
- ▶ Gently lever the cam forward until it disengages from the arm spindle.
- ▶ Rotate the arm to re-hand the unit the required way (ensure the cam is fully engaged).

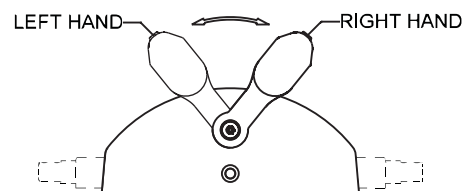

INSERT FLAT SCREWDRIVER HERE

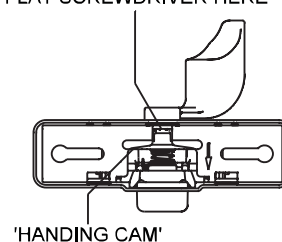

4.5 IQ Bar 202 V

These units can be fitted on a single door or on rebated double doors together with a latch unit. In this case a revised fitting position is required, which is shown in the relevant section of these instructions relating to that device.

Step A: Preparing the device

- ▶ Hand the main unit by removing the packaging and gently rotate the arm in the required direction (see diagram Step I) until it clicks. The unit is now handed. If handed incorrectly by mistake refer to Step I.
- ▶ Remove the mounting plate from the bottom of the main operating unit (pull out).

Step B: Fitting the mounting plate

- ▶ Determine the centre height of the unit between 930mm and 1130mm from floor level. Mark this position on the edge of the door frame, both sides of the inside of the door.



Note: The centre of the Push Bar will fall approximately 30mm below this.

- ▶ For rebated single doors: starting at the opening edge, place the template (DT-0071) on the door and slide into the jamb rebate (you may need to cut or fold the template), align with the unit centre line and the jamb line and stick to the door with sticky tape.
For **flush doors** align the correct line on the template (DT-0072) with the frame edge and the unit centre line. Mark the positions of the holes for the mounting plate. Follow the instructions on the template and drill the required holes.
- ▶ Fix the mounting plate to the door.



All six fixing holes must be used and screw heads must not project above plate.

- ▶ Hand the slave, same process as the main unit (Step A), but the opposite hand.
- ▶ Repeat steps above to fit the slave unit mounting plate to the hinge side of the door. Fix this mounting plate to the door also using all 6 fixing screws.



In case of using an outside access device (lever) pause the installation of the exit device and fit the lever before continuing with the installation. Refer to chapter Lever 200 L - (OAD)

Step C: Preparing the shoot tubes.



Rotate the mounting plate cam to the correct position (see template) and fit the main unit onto the mounting plate.

- ▶ Temporarily secure using one of the supplied M5 x 8 CSK screws.
- ▶ Measure accurately the bottom length (G), Subtract 111mm and cut the **plain end** of the

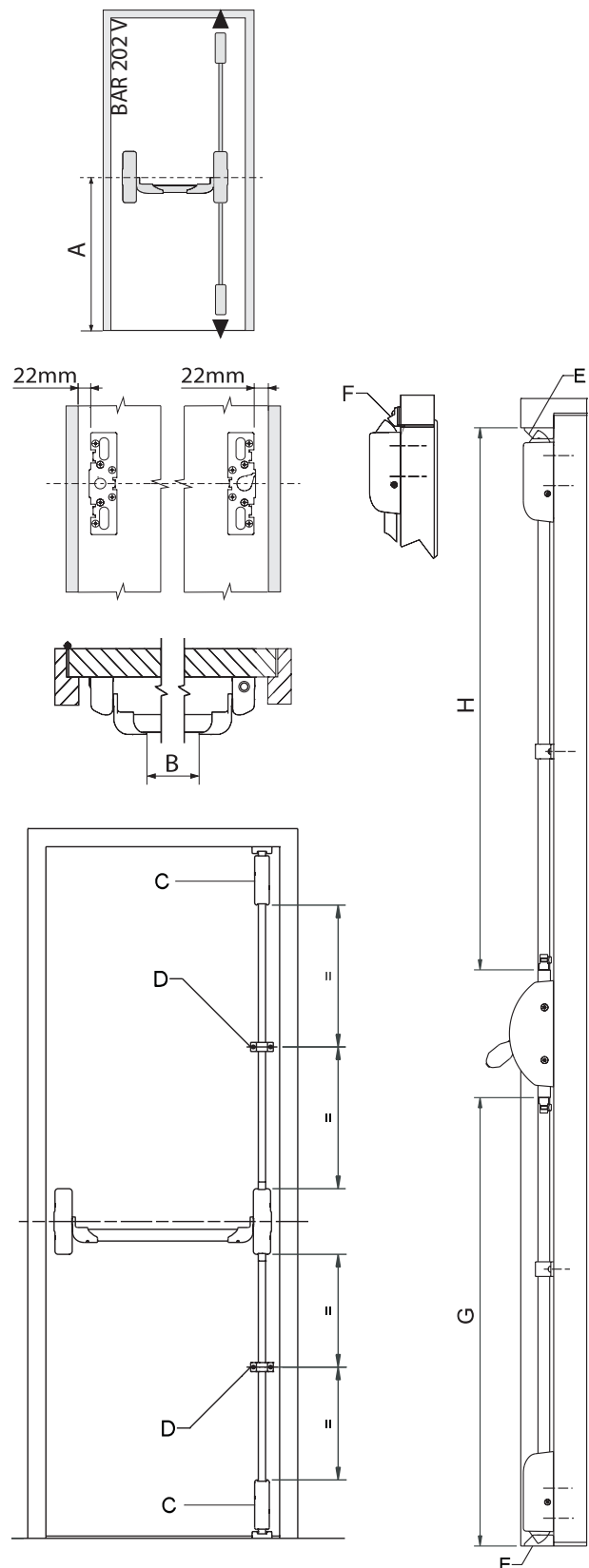

- A Unit Centre Height: A = between 930mm & 1130mm
- B Oval Push Bar Length = B + 61mm
- C Pullman catch
- D Top/Bottom Guide
- F Pullman Flush Door Keep No. 406A
- E Top/Bottom Keep
- G Bottom Shoot Tube Length = G - 111mm
- H Top Shoot Tube Length = H - 111mm

shorter tube to this length.

- ▶ Measure accurately the top length H, Subtract 111mm and cut the **plain end** of the **longer tube** to this length. (For flush doors subtract 101mm)
- ▶ Using the installation drift tube to prevent screw thread damage, drive the threaded shoot end plug into cut ends of both tubes. Plug **must** be driven in fully against the tube end.

Step D: Positioning and fitting the pullman catches.

- ▶ To establish the mounting position for the top and bottom pullman catches first determine which type of keep/striker is required for the installation. Standard door/floor keep (included) or Pullman flush door keep No. 406A (F) (see diagram).
- ▶ Place the template (DT-0073) on the door. Line up the appropriate lines. Mark the corresponding holes.
- ▶ Follow the instructions on the relevant template and drill the required holes.
- ▶ Remove the covers from the pullman catches (two cover screws)
- ▶ Fit the pullman catches, using CSK screws provided. Re-fit the covers.

Step E: Fitting the shoot tubes, guides & main unit.

- ▶ Remove the main unit from the door.
- ▶ Screw the previously prepared shoot tubes (section B) fully into the pullman catches.
- ▶ Slide the guides onto the tubes (one on each tube)
- ▶ Ensure the mounting plate cam is in the correct position (see template).
- ▶ Place the main unit onto the mounting plate allowing the tubes to drift to one side.
- ▶ Operate the main unit mechanism to retract the shoot spigots. Guide the shoot tubes into position and slowly release the mechanism whilst guiding the spigots into the end of the tubes.
- ▶ Unscrew the tubes from the pullman catches until they almost contact the shoulder on the shoot spigots. Rotate the tubes back until the holes are facing the door.
- ▶ Pull the unit away from the door and fix the tubes using the M5x10 cap head screws provided.
- ▶ Fit unit back on the mounting plate and secure using three M5x8 CSK Screws.
- ▶ Locate the guides equidistant on the tubes (see diagram) and secure using the round headed screws provided. Ensuring the tubes are vertical and the guides are in alignment.

Step F: Fitting the keeps.

- ▶ Position the top/bottom keeps centred about the catch with the square face of the keep against the door (see diagram) and mark the holes. Fix in place using the countersunk

screws provided. For flush door use keep No. 406A. Fit as shown and adjust with packers until the correct engagement is achieved.

Step G: Fitting the slave unit & oval cross bar.

- ▶ Temporarily fit the slave unit to the mounting plate.
- ▶ Measure accurately the arm gap (B) (see diagram) add 61mm to this dimension and cut oval cross bar to this length.
- ▶ Remove slave unit from its mounting plate insert one end of oval cross bar into the main unit arm and the other into the slave unit arm.
- ▶ Refit the slave unit to the mounting plate and secure using three M5x8 CSK Screws provided.



- ▶ Secure the cross bar with the two of M4x6 set screws one in each arm.

DO NOT OVER TIGHTEN

Step H: Testing the operation & fitting the sign.

- ▶ Test the unit to ensure that when the Push Bar is operated the door opens immediately and swings freely and when the door is closed the pullman catches engage fully in the keeps and hold the door securely closed.
- ▶ Fit the green self adhesive 'Push Bar to Open' sign onto the door positioned immediately above the push bar.

Step I: Re-Handing the unit (If required)

If either unit is handed the wrong way in error, please follow these instructions.

- ▶ Turn the unit upside down & pull out the mounting plate to remove it (if required)
- ▶ Slide a small flat bladed screwdriver into the smaller bit of the large aperture along the inside face of the steel chassis inserting it between the chassis and the handing cam (see the diagram).
- ▶ Gently lever the cam forward until it disengages from the arm spindle.
- ▶ Rotate the arm to re-hand the unit the required way (ensure the cam is fully engaged).

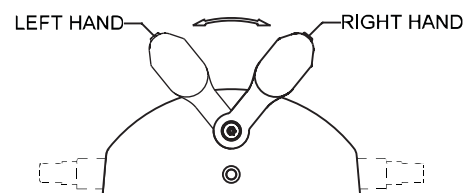

INSERT FLAT SCREWDRIVER HERE

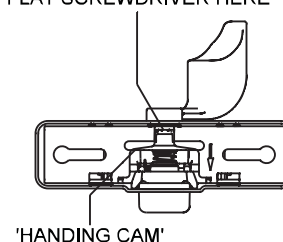

4.6 Lever 200 L - Outside Access Device (OAD)

This outside access device provides a lockable entry facility for doors fitted with IQ 200 SERIES. The outside access device always allows immediate exit regardless of whether device is locked or unlocked.

For double door installations with rebated meeting door styles, the outside access device must be fitted on the first opening (last closing) door leaf.

- 1 Additional Fixing Hole (Use when mounted on LH Outside Door Face)
- 2 Additional Fixing Hole (Use when mounted on RH Outside Door Face)
- 3 Backplate Fixing Screws (4 off)
- 4 Backplate Assembly
- 5 Mounting Bushes
- 6 Drive Spindle (Note: Setting Marks)
- 7 Lever Spring
- 8 Sprung Disc
- 9 Lever
- 10 Lever Drive Pin (spring loaded)
- 11 Lever Set Pin

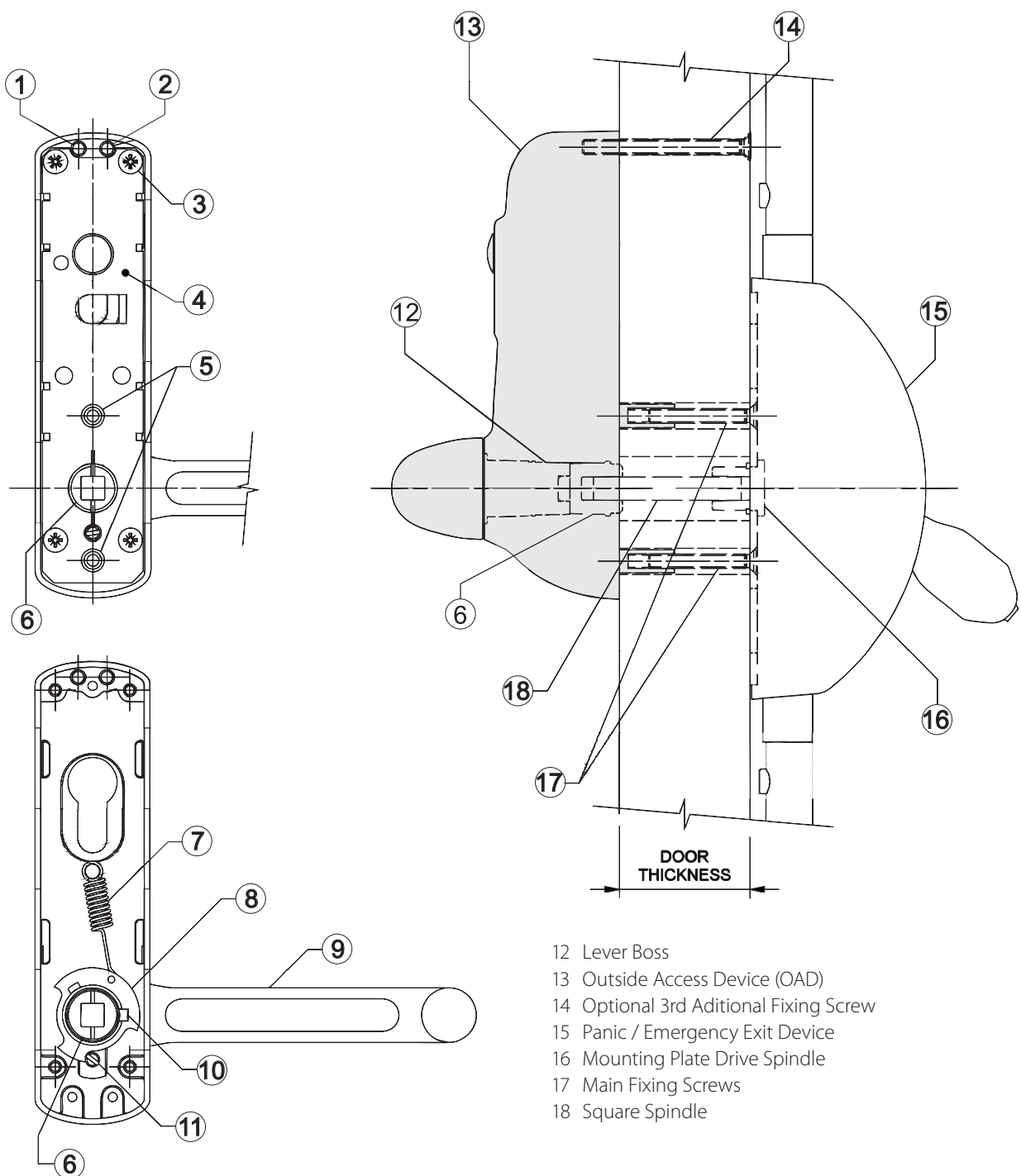

- 12 Lever Boss
- 13 Outside Access Device (OAD)
- 14 Optional 3rd Additional Fixing Screw
- 15 Panic / Emergency Exit Device
- 16 Mounting Plate Drive Spindle
- 17 Main Fixing Screws
- 18 Square Spindle

4.6.1 Preparing the device

Step A: Setting the outside access device's lever for left or right hand opening doors

- ▶ First establish the lever handing direction required by checking its position on the door.
- ▶ Remove the label & packing and gently rotate the lever in the required direction, until you feel / hear the drive assembly engage.
- ▶ Continue to move the lever against the spring pressure until it's just past the horizontal position.
- ▶ Hold the lever still and carefully insert the supplied lever set pin (11), through the hole in the back plate (4). Engage the thread and tighten. The lever is now set.

Step B: Re-setting the outside access device's lever if set the wrong way in error

- ▶ Operate the cylinder lock key in an anti-clockwise. Remove the key.
- ▶ Remove the backplate assembly (4) (4 screws). Taking care not to displace the drive spindle (6) from the lever boss (12).
- ▶ Remove the lever set pin (11) (if it has been fitted)
- ▶ Look inside the body. Locate the lever drive pin (10). Depress the spring loaded lever drive pin to disengage the lever (9) from, the sprung disc (8).
- ▶ Gently rotate the lever towards the correct position until the drive lever drive pin (10) reengages. Taking care not to rotate the 'sprung disc'.
- ▶ Continue to move the lever against the spring pressure until it's just past the horizontal position and the lever drive pin engages in the new position. Fit the lever set pin to retain the lever in its new position.
- ▶ Refit the backplate assembly (4) (4 screws). Line up the setting marks on the drive spindle (6) with those on the backplate assembly. Test the operation of the unit.

OPTIONAL 3RD ADDITIONAL FIXING

For added security a third mounting screw is provided for an additional outside access device fixing. However this extra screw is only hidden from view when used in conjunction with two & three point exit units (by the shoot tube), but is visible on the inside face of the door on single point (latch) versions.

4.6.2 Fitting the device

If this unit is to be fitted at the same time as the exit unit follow step C, if the unit is to be retrofitted to an existing installation follow step D.

Step C: Positioning the device: When fitting at the same time as the exit device

- ▶ Ensure the correct holes are drilled when fitting the exit device main operating unit's mounting plate, by following the instructions on the template supplied with the exit device.
- ▶ After fitting the mounting plates (section A on the exit device's fitting instructions) pause with the installation of the exit device and fit the outside access device before continuing with its installation.

Step D: Positioning the device: When retrofitting for use with an existing exit device

- ▶ First remove the exit device's main unit from the door. But leave the mounting plates in place. Refer to the units fitting instructions for help (general removal procedure listed below)
 - Slacken the arm retaining screws using 2mm Allen key (Push Bar Versions only)
 - Remove the slave unit (three screws, No.2 Pozi) & cross bar, DO NOT remove its mounting plate (Push Bar Versions only)
 - Remove the three main operating unit fixing screws (No.2 Pozi). Single point latch units can now be removed.
 - Bolt Versions: unscrew the three guides & top trip (eight screws, No.2 Pozi). The unit can now be carefully removed from the door.
 - Pullman Catch versions: Remove the Pullman catches (No.2 Pozi screws, two each cover). Unscrew the two guides (four screws, each). Unscrew the Pullman catches (three screws, each). The unit can now be carefully removed from the door.
- ▶ Remove main units mounting plate from the door (six screws).
- ▶ Locate the large 22mm Diameter spindle hole (blind hole). Drill this hole fully through the door.
- ▶ Locate the two screw holes immediately above and below the large spindle hole. Open up these two screw holes to 9mm Diameter. And drill fully through the door.

Step E: Positioning the 3rd additional fixing

- ▶ Mark a centre line vertically on the outside face of the door:
 - Standard rebated door centre line = 34mm from edge of door frame
 - Flush door centre line = 22mm from edge of door frame
 - Double rebated door centre line = 22mm* from outermost edge of last opening door leaf



Tip: measure from inner edge of the rebate & add the rebate width to the dimension

Note: the centre line should pass through the centre of the 3 holes (2 x Ø9mm & 1 x Ø22mm) as drilled from the other side of the door.

- ▶ Align the template (DT-0075) with the marked centre line and the three holes. Using the template mark & drill the correct 3rd additional fixing hole (see diagram pos. (1) or (2)) through the door.
Countersink this hole on the inside face of the door to suit the screw head with the dished washer (to stop it from pulling through the door face on timber doors).
- ▶ Prepare the 3rd additional fixing screw (14):
Take one of the three supplied special M5x70 CSK screws; measure the door thickness, add 13mm to this size and cut this screw to this length (length includes head).

Step F: Preparing the 'main fixing screws' & 'square spindle'

- ▶ Take two of the three supplied special M5x70 CSK screws; measure the door thickness, less 8mm from this size and cut the two screws to this length (length includes head).
- ▶ Measure the door thickness; add 6mm to this size and cut the supplied square spindle (18) to this length. Remove the fray from the cut end with a file.

Step G: Fitting the outside access device

- ▶ Re-fit the exit device main operating unit's mounting plate (if removed, section D).
- ▶ Insert the previously prepared spindle (section E) through the large diameter hole; into the mounting plate drive spindle (16).
- ▶ Rotate mounting plate drive spindle (16) to the correct position: should be sitting at an angle 45 degrees pointing in an upwards direction (e.g. northwest or north-easterly direction)
- ▶ Fit the outside access device to the door ensuring the spindle locates correctly in the OAD drive spindle (6). Ensure the setting marks are in alignment with ones on the backplate.
- ▶ Secure to the door using the previously prepared (section E) main fixing screws (17) and the 3rd additional fixing screw (14) if required.
- ▶ **Ensure mounting plate drive spindle (16) is in the correct position!**
- ▶ Operate the device to ensure the mounting plate drive spindle (16) rotates freely.
- ▶ Install / Re-install the exit device referring to its installation instructions.

Step H: Testing the device

- ▶ Once the exit device has been installed / re-installed; test for free and correct operation of both the outside access device & the exit device/s.

5 Notes on installation

As part of the requirements of EN1125: 2008 (Panic Exit devices) / EN179: 2008 (Emergency Exit devices) we must provide you with the following additional information. The safety features of this product are essential to its compliance with EN179 / EN1125: 2008. No modifications of any kind, other than described in these instructions are permitted.

- All devices are suitable for use on double / single doors up to 2440mm x 1220mm, door mass up to 200kg.
- Before fitting an exit device to a door, the door should be checked to ensure correct hanging and freedom from binding. A maximum of 5mm door distortion is allowed. We do not recommend that any of our exit devices be fitted to hollow core doors. It is recommended to verify that the door construction allows the use of the device, i.e. verify that:
 - Offset hinges and engaging leaves allow both leaves to be opened simultaneously.
 - The gap between door leaves does not differ from that which is specified in the main installation instructions (if stated).
 - The operating elements do not interfere.

NOTE: Panic / Emergency exit devices manufactured in accordance with EN1125 & EN179 will provide a high degree of safety and reasonable security provided that they are fitted to doors and door frames that are in good condition.

- Before fitting a Panic / Emergency exit device to a fire / smoke resisting door, the fire certification of the fire door assembly on which the exit device has been tested (to prove suitability for use on fire doors) should be examined. It is of utmost importance that an exit device is not used on a fire door assembly of a greater fire resistance time than it is approved for.
- Care should be taken to ensure that any seals or weather-stripping fitted to the complete door assembly, does not inhibit the correct operations of the Panic / Emergency exit device.
- On double door sets with rebated meeting stiles and where both leaves are fitted with Panic / Emergency exit devices, it is essential to check that either leaf will open when its exit device is activated and also that both leaves will open freely when both exit devices are operated simultaneously.
- These Panic / Emergency exit devices are manufacture in one size.
- Category 2 (standard projection) Panic / Emergency exit devices should be used in situations where there is restricted width for escape, or where the doors to be fitted with the Panic / Emergency exit devices are not able to open beyond 90°.
- Where an exit device is to be fitted to a glazed door, it is essential that the glazing is tempered or laminated glass.
- None of our Panic / Emergency exit devices are intended for use on double action (double swing) doors.
- The fixing instructions should be carefully followed during installation. These instructions should be passed on by the installer to the user.
- The horizontal bar (EN1125 devices) / operating element (EN179 devices) should normally be installed at a height of between 900 mm and 1100 mm from the finished floor level, when the door is in the secured position. Where it is known that the majority of the occupants of the premises will be young children, consideration should be given to reducing the height of the bar / operating element accordingly.
- The horizontal bar should be installed so as to provide the maximum effective length (EN1125 devices)
- When installing (EN179) lever operated Emergency exit devices, particularly on doors with raised or recessed surfaces, consideration should be given to minimizing any potential safety risks, such as the trapping of fingers or clothing.
- The bolt heads / latches and keepers should be fitted to provide secure engagement. Care should be taken to ensure that no projection of the bolt heads / latches, when in the withdrawn position, can prevent the door swinging freely.
- Where exit devices are to be fitted to double doorsets with rebated meeting stiles and self closing devices, a door coordinator device in accordance with EN 1158 should be fitted to ensure the correct closing sequence of the doors. This recommendation is particularly important with regard to fire/smoke resisting door assemblies.
- No additional devices for securing the door in the closed position should be fitted. This does not preclude the installation of self closing devices.
- If a door closing device is to be used to return the door to the closed position, care should be taken not to impair the use of the doorway by the young, elderly and infirm.
- Any keepers or protection plates provided should be fitted in order to ensure compliance with EN1125 / EN179.
- EN1125 Panic exit devices: the provided sign which reads; "Push bar to open" should be affixed on the inside face of the door immediately above the horizontal bar.
- EN179 Emergency exit devices: the provided sign which reads; "Push Pad to open" should be affixed on the inside face of the door immediately above the Push Pad operating element.

6 Maintenance instructions

It is important that all a panic and emergency exit hardware devices are inspected and maintained properly to ensure safety is maintained when exiting a building in any situation. Once the device is fitted regular maintenance is recommended.

Weekly:

- ▶ Make sure the Exit Device functions correctly.
- ▶ Any fixings that have worked loose should be re-secured
- ▶ Any damaged components should be replaced.
- ▶ Ensure there are no obstructions which prevent the exit unit from functioning correctly.

Every three months:

- ▶ Check for wear, any visible worn components should be replaced.

The following is the routine maintenance procedure as recommended by EN1125 / EN179:-

- ▶ Inspect and operate the exit device to ensure that all components are in a satisfactory working condition. If possible using a force gauge, measure and record the operating forces to release the exit device.
- ▶ Ensure the keeper(s) is (are) free from obstruction.
- ▶ Check that the exit device is lubricated in accordance with the producer's instructions.
- ▶ Check that no additional locking devices have been added to the door since its original installation.
- ▶ Check periodically that all components of the system are still correct in accordance with the list of approved components originally supplied with the system.
- ▶ Check periodically that the operating element is correctly tightened and, if possible using a force gauge, measure the operating forces to release the exit device. Check that the operating forces have not changed significantly from the operating forces recorded when originally installed.

7 Drilling templates

Overview

- Drilling Template 0071 - Main Unit / Slave Fitting Template
- Drilling Template 0072 - Flush Doors / 1st Opening Double Door
- Drilling Template 0073 - Vertical Pullman Catches Fitting Template
- Drilling Template 0074 - Horizontal Pullman Catches Fitting Template
- Drilling Template 0075 - Lever 200 L - Template for positioning optional 3rd additional fixing hole

7.1 Drilling Template 0071 - Main Unit / Slave Fitting Template

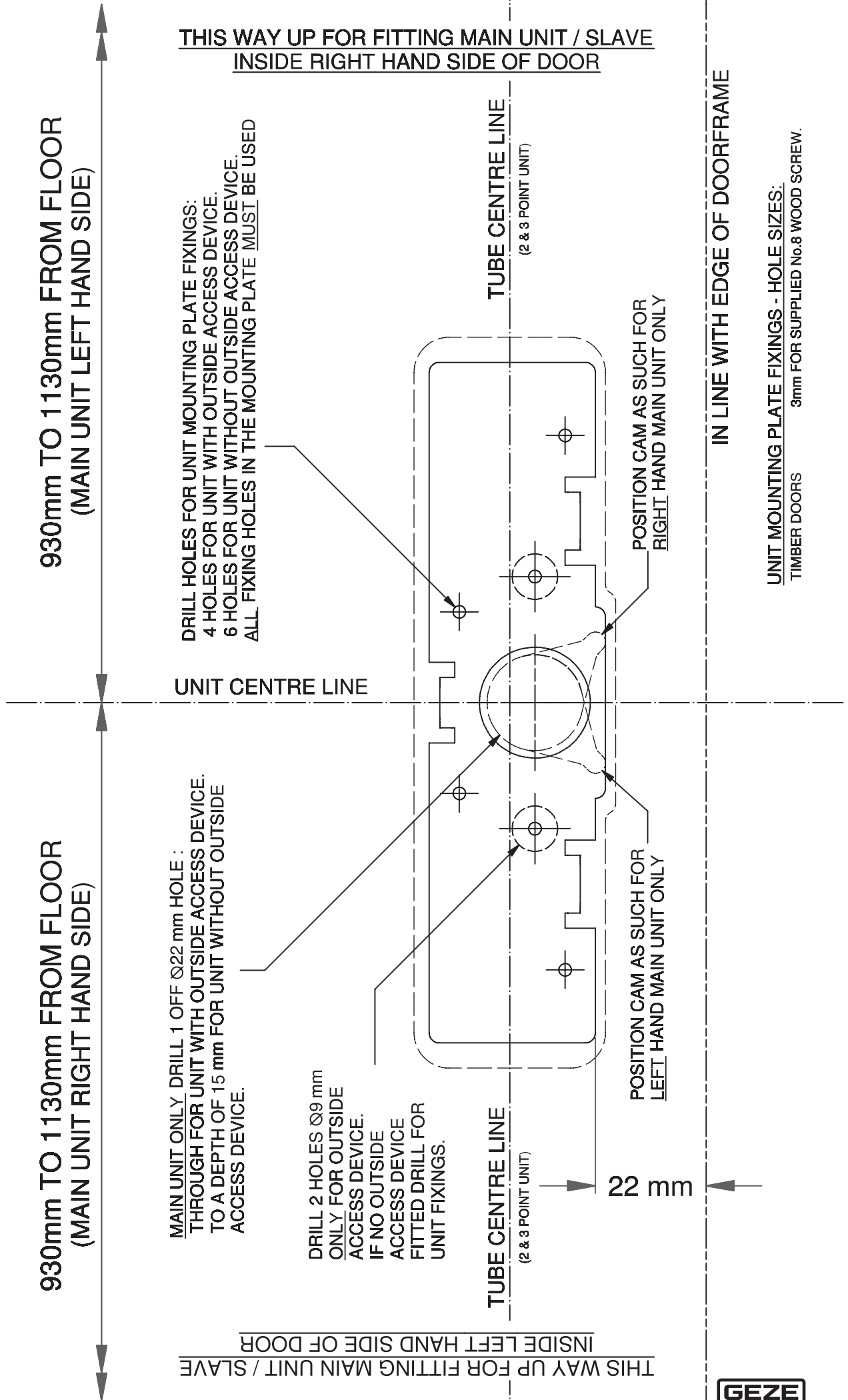

UNIT MOUNTING PLATE FIXINGS - HOLE SIZES:
TIMBER DOORS 3mm FOR SUPPLIED No.8 WOOD SCREW.



7.2 Drilling Template 0072 - Flush Doors / 1st Opening Double Door

930mm TO 1130mm FROM FLOOR
(MAIN UNIT RIGHT HAND SIDE)

930mm TO 1130mm FROM FLOOR
(MAIN UNIT LEFT HAND SIDE)

THIS WAY UP FOR FITTING MAIN UNIT / SLAVE
INSIDE LEFT HAND SIDE OF DOOR

THIS WAY UP FOR FITTING MAIN UNIT / SLAVE
INSIDE RIGHT HAND SIDE OF DOOR

MAIN UNIT ONLY DRILL 1 OFF $\varnothing 22$ mm HOLE :
THROUGH FOR UNIT WITH OUTSIDE ACCESS DEVICE.
TO A DEPTH OF 15 mm FOR UNIT WITHOUT OUTSIDE
ACCESS DEVICE.

DRILL HOLES FOR UNIT MOUNTING PLATE FIXINGS:
4 HOLES FOR UNIT WITH OUTSIDE ACCESS DEVICE.
6 HOLES FOR UNIT WITHOUT OUTSIDE ACCESS DEVICE.
ALL FIXING HOLES IN THE MOUNTING PLATE MUST BE USED

DRILL 2 HOLES $\varnothing 9$ mm
ONLY FOR OUTSIDE
ACCESS DEVICE.
IF NO OUTSIDE
ACCESS DEVICE
FITTED DRILL FOR
UNIT FIXINGS.

UNIT CENTRE LINE

TUBE CENTRE LINE
(2 & 3 POINT UNIT)

TUBE CENTRE LINE
(2 & 3 POINT UNIT)

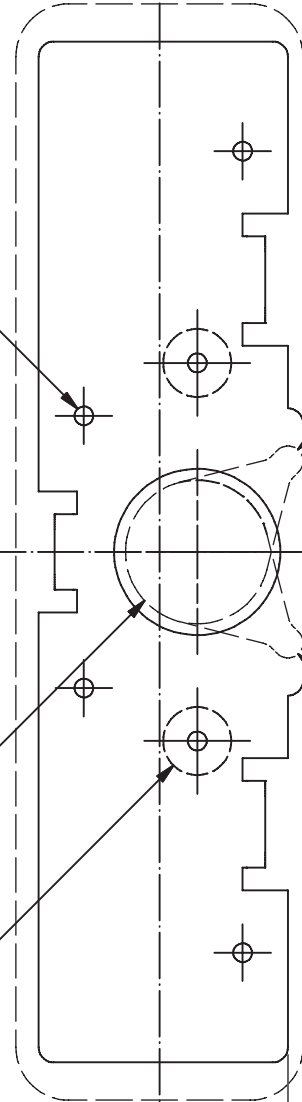

POSITION CAM AS SUCH FOR
LEFT HAND MAIN UNIT ONLY

POSITION CAM AS SUCH FOR
RIGHT HAND MAIN UNIT ONLY

7.3 Drilling Template 0073 - Vertical Pullman Catches Fitting Template

HOLE SIZES:
TIMBER DOORS: PILOT \varnothing 3mm FOR SUPPLIED No.8 WOOD SCREW.

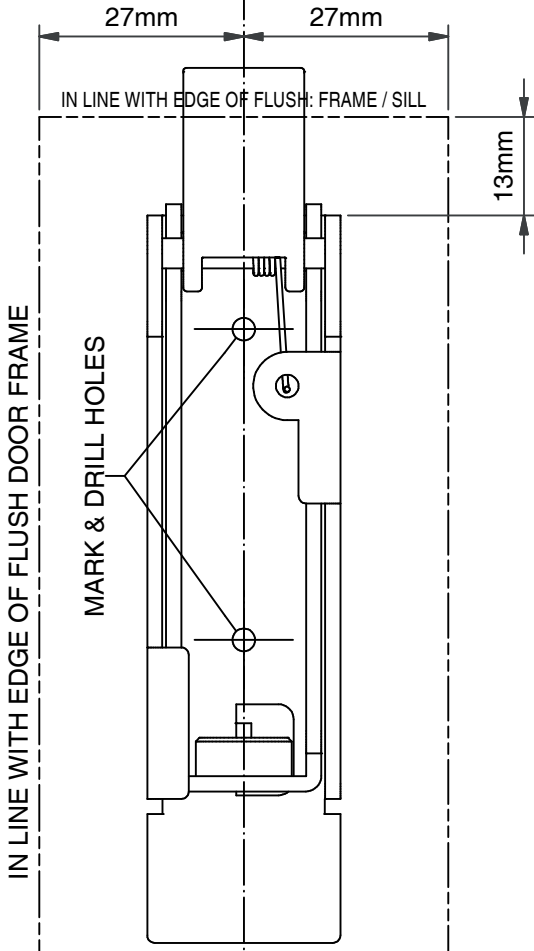
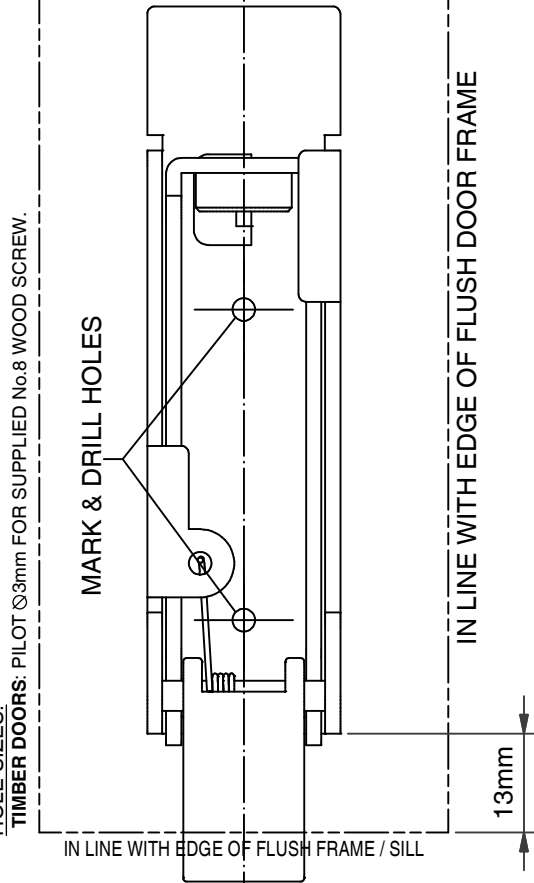

DOUBLE DOOR: IN LINE WITH EDGE OF INACTIVE (2nd OPENING) DOOR

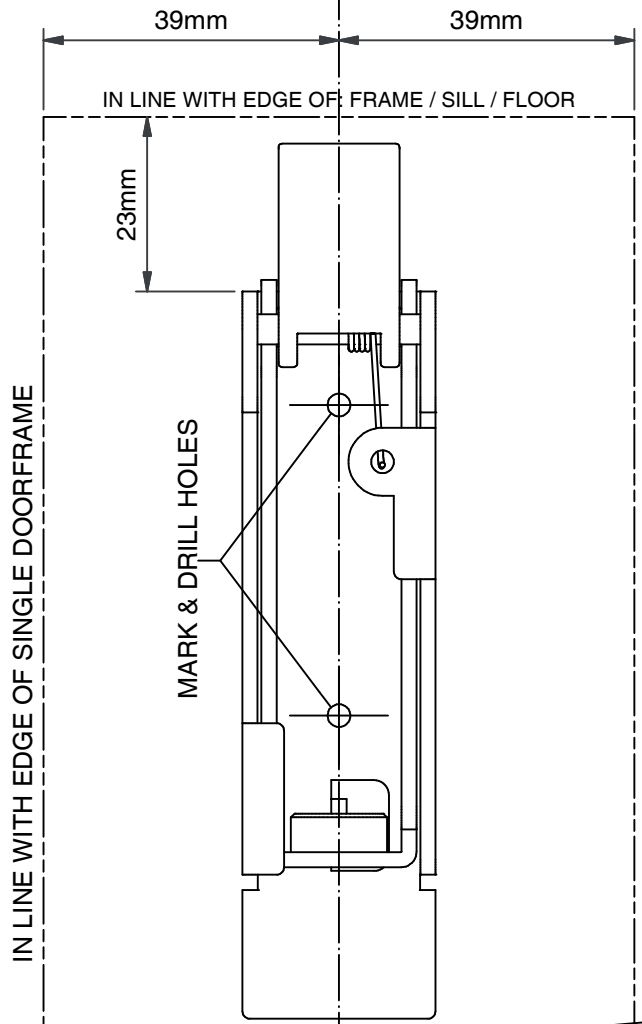
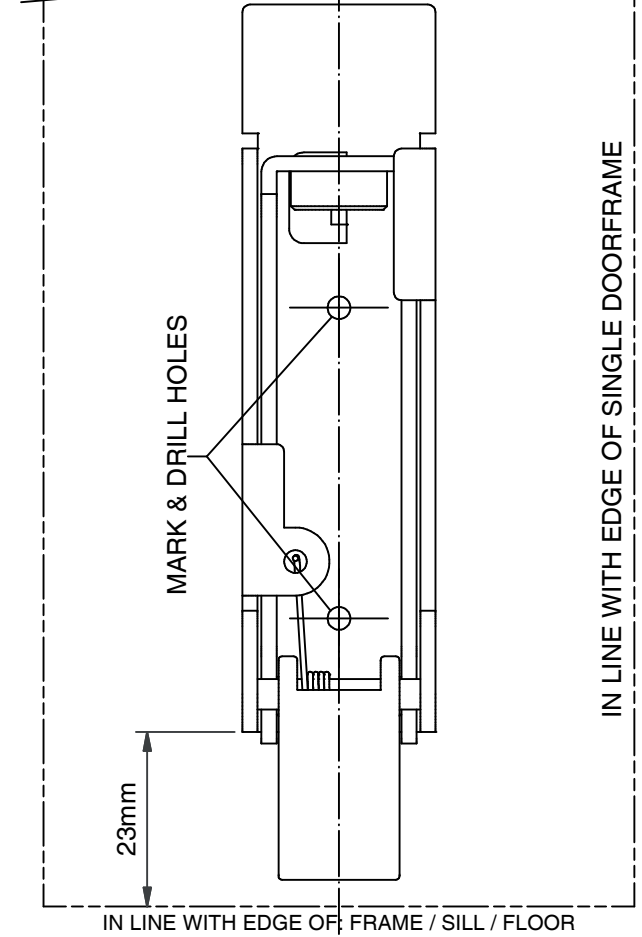

7.4 Drilling Template 0074 - Horizontal Pullman Catches Fitting Template

HOLE SIZES:
TIMBER DOORS: PILOT \varnothing 3mm FOR SUPPLIED No.8 WOOD SCREW.

THIS WAY UP FOR DOORS HUNG ON THE **RIGHT** HAND SIDE

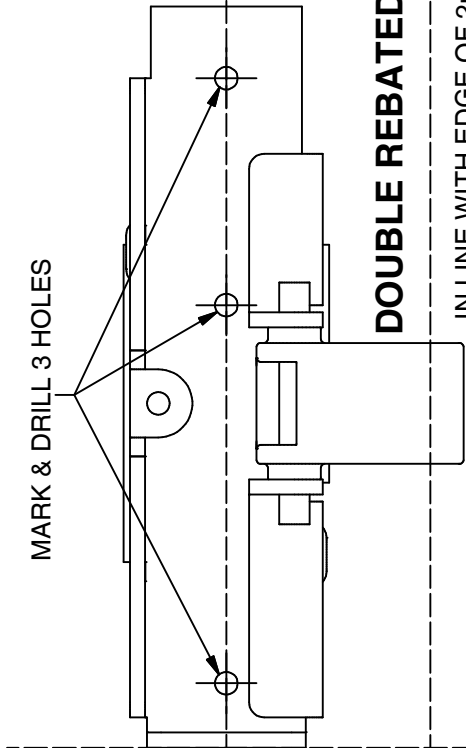

DOUBLE REBATED DOORS

IN LINE WITH EDGE OF 2nd OPENING (INACTIVE) LEAF / FLUSH DOOR FRAME

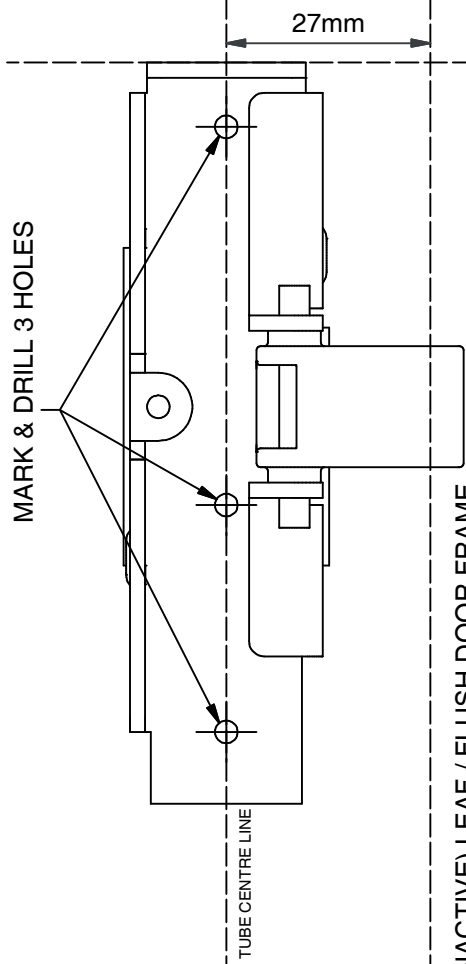

THIS WAY UP FOR DOORS HUNG ON THE **LEFT** HAND SIDE

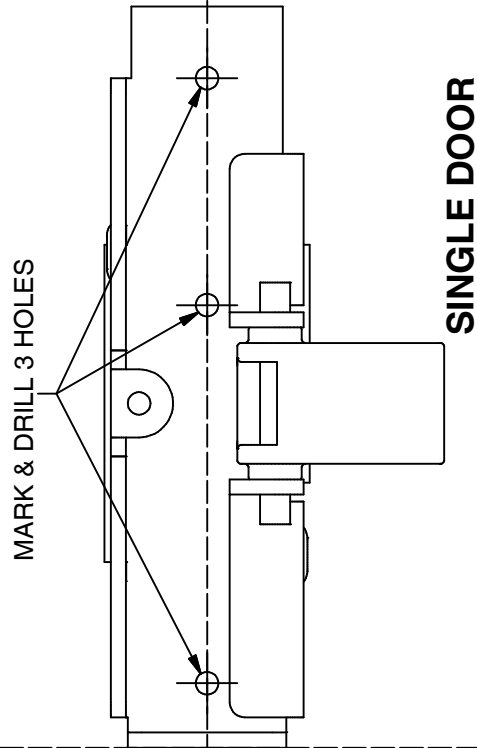

SINGLE DOOR

IN LINE WITH EDGE OF SINGLE DOORFRAME

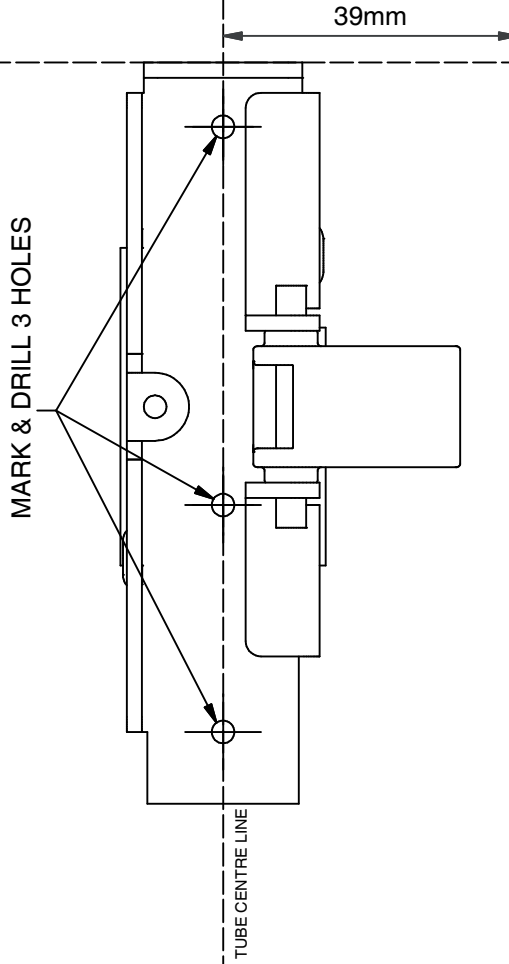

TOP OUTSIDE DOOR FACE

ADDITIONAL FIXING HOLE
DRILL THIS HOLE $\varnothing 5.5\text{mm}$
FOR DEVICE MOUNTED ON
RH OUTSIDE DOOR FACE.
CSK OTHER SIDE.

ADDITIONAL FIXING HOLE
DRILL THIS HOLE $\varnothing 5.5\text{mm}$
FOR DEVICE MOUNTED ON
LH OUTSIDE DOOR FACE.
CSK OTHER SIDE.

7.5 Drilling Template 0075 - Lever 200 L - Template for positioning optional 3rd additional fixing hole

TYPICAL WOODEN DOOR/S.

* $\varnothing 9\text{mm}$ HOLE

* $\varnothing 22\text{mm}$ HOLE

* $\varnothing 9\text{mm}$ HOLE

OUTSIDE ACCESS DEVICE CENTRE LINE

**DO NOT USE THIS TEMPLATE
TO DRILL THESE HOLES.
FOR TEMPLATE ALIGNMENT ONLY!
OPEN UP / DRILL THROUGH
EXISTING HOLES OR DRILL NEW HOLES
USING PANIC DEVICES TEMPLATE
DT 0071 / DT 0072 AS APLICABLE.*

LISTED ACCESSORIES



Only the accessories listed below can be used with this product range.
The use of any other accessory may invalidate the relevant products EN1125 / EN179 CE certification.

PRODUCT No.	DESCRIPTION	COMPATIBILITY
OUTSIDE ACCESS DEVICES		
200 L	Lever operated Outside Access Device with Euro aperture (cylinder not supplied)	Use with all IQ Bar 200 series range
200 L EC	Lever operated Outside Access Device with Euro cylinder	
KEEPS		
3405	Surface mounted Bottom bolt Keep	use with: IQ Bar 202 V A & IQ Bar 203 V A
3405A	Surface mounted Top Trip Keep	use with: IQ Bar 202 V A & IQ Bar 203 V A
P0401	Standard Top Trip Plate	as supplied with: IQ Bar 202 V A & IQ Bar 203 V A
P1301	Standard Floor Plate bolt keep.	as supplied with: IQ Bar 202 V A & IQ Bar 203 V A
SL-0144	Centre Latch Keep for rebated double / flush doors	use with: IQ Bar 201, IQ Bar 203
406A	Pullman Latch Keep for rebated double / flush doors	use with: IQ Bar 201, IQ Bar 203

Unless other wise stated compatibility is assumed with all the various suffixed variations (e.g. 'A', '-B', '-P', '/SD', '/UP & /AD:') of the basic product.

CE MARKING

All devices are intended for use on single / double outward opening route escape doors, none-fire rated.
Minimum resistance for all devices: a maximum pulling force of 1000N was achieved against the fixings under the abuse test.
Below is the CE marking information for the entire range. Applicable products are clearly listed below their relevant markings.

 1121 EN 1125: 2008 PANIC EXIT DEVICES <table border="1" style="margin: auto;"> <tr> <td>3</td><td>7</td><td>6</td><td>0</td><td>1</td><td>3</td><td>2</td><td>2</td><td>A</td><td>A</td> </tr> </table> AAA044 11	3	7	6	0	1	3	2	2	A	A	 1121 EN 179: 2008 PANIC EXIT DEVICES <table border="1" style="margin: auto;"> <tr> <td>3</td><td>7</td><td>6</td><td>0</td><td>1</td><td>3</td><td>2</td><td>2</td><td>B</td><td>A</td> </tr> </table> ABB049 11	3	7	6	0	1	3	2	2	B	A
3	7	6	0	1	3	2	2	A	A												
3	7	6	0	1	3	2	2	B	A												
Category 2 Projection. Field of Door application: Category A (Single & Double) -	Category 2 Projection. Field of Door application: Category A (Single & Double) -																				
Applicable to Products: IQ Bar 201, IQ Bar 202 V, IQ Bar 202 V A, IQ Bar 203 V A, IQ Bar 203 H, IQ Bar 203 V DL, IQ Bar 204 V DL	Applicable to Products: IQ Pad 201, IQ Pad 202 V A, IQ Pad 203 H																				
GEZE GmbH, Reinhold-Vöster-Str. 21-29, D-71229 Leonberg																					

Germany
GEZE GmbH
Niederlassung Süd-West
Tel. +49 (0) 7152 203 594
E-Mail: leonberg.de@geze.com

GEZE GmbH
Niederlassung Süd-Ost
Tel. +49 (0) 7152 203 6440
E-Mail: muenchen.de@geze.com

GEZE GmbH
Niederlassung Ost
Tel. +49 (0) 7152 203 6840
E-Mail: berlin.de@geze.com

GEZE GmbH
Niederlassung Mitte/Luxemburg
Tel. +49 (0) 7152 203 6888
E-Mail: frankfurt.de@geze.com

GEZE GmbH
Niederlassung West
Tel. +49 (0) 7152 203 6770
E-Mail: duesseldorf.de@geze.com

GEZE GmbH
Niederlassung Nord
Tel. +49 (0) 7152 203 6600
E-Mail: hamburg.de@geze.com

GEZE Service GmbH
Tel. +49 (0) 1802 923392
E-Mail: service-info.de@geze.com

Austria
GEZE Austria
E-Mail: austria.at@geze.com
www.geze.at

Baltic States –
Lithuania / Latvia / Estonia
E-Mail: baltic-states@geze.com

Benelux
GEZE Benelux B.V.
E-Mail: benelux.nl@geze.com
www.geze.be
www.geze.nl

Bulgaria
GEZE Bulgaria - Trade
E-Mail: office-bulgaria@geze.com
www.geze.bg

China
GEZE Industries (Tianjin) Co., Ltd.
E-Mail: chinasales@geze.com.cn
www.geze.com.cn

GEZE Industries (Tianjin) Co., Ltd.
Branch Office Shanghai
E-Mail: chinasales@geze.com.cn
www.geze.com.cn

GEZE Industries (Tianjin) Co., Ltd.
Branch Office Guangzhou
E-Mail: chinasales@geze.com.cn
www.geze.com.cn

GEZE Industries (Tianjin) Co., Ltd.
Branch Office Beijing
E-Mail: chinasales@geze.com.cn
www.geze.com.cn

France
GEZE France S.A.R.L.
E-Mail: france.fr@geze.com
www.geze.fr

Hungary
GEZE Hungary Kft.
E-Mail: office-hungary@geze.com
www.geze.hu

Iberia
GEZE Iberia S.R.L.
E-Mail: info.es@geze.com
www.geze.es

India
GEZE India Private Ltd.
E-Mail: office-india@geze.com
www.geze.in

Italy
GEZE Italia S.r.l
E-Mail: italia.it@geze.com
www.geze.it

GEZE Engineering Roma S.r.l
E-Mail: italia.it@geze.com
www.geze.it

Korea
GEZE Korea Ltd.
E-Mail: info.kr@geze.com
www.geze.com

Poland
GEZE Polska Sp.z o.o.
E-Mail: geze.pl@geze.com
www.geze.pl

Romania
GEZE Romania S.R.L.
E-Mail: office-romania@geze.com
www.geze.ro

Russia
OOO GEZE RUS
E-Mail: office-russia@geze.com
www.geze.ru

Scandinavia – Sweden
GEZE Scandinavia AB
E-Mail: sverige.se@geze.com
www.geze.se

Scandinavia – Norway
GEZE Scandinavia AB avd. Norge
E-Mail: norge.se@geze.com
www.geze.no

Scandinavia – Denmark
GEZE Danmark
E-Mail: danmark.se@geze.com
www.geze.dk

Singapore
GEZE (Asia Pacific) Pte, Ltd.
E-Mail: gezesea@geze.com.sg
www.geze.com

South Africa
GEZE South Africa (Pty) Ltd.
E-Mail: info@gezesa.co.za
www.geze.co.za

Switzerland
GEZE Schweiz AG
E-Mail: schweiz.ch@geze.com
www.geze.ch

Turkey
GEZE Kapı ve Pencere Sistemleri
E-Mail: office-turkey@geze.com
www.geze.com

Ukraine
LLC GEZE Ukraine
E-Mail: office-ukraine@geze.com
www.geze.ua

United Arab Emirates/GCC
GEZE Middle East
E-Mail: gezeme@geze.com
www.geze.ae

United Kingdom
GEZE UK Ltd.
E-Mail: info.uk@geze.com
www.geze.com

GEZE GmbH
Reinhold-Vöster-Straße 21–29
71229 Leonberg
Germany

Tel.: 0049 7152 203 0
Fax.: 0049 7152 203 310
www.geze.com

